

SITE PLAN OF THE PLOT OF LAND AT PREMISES NO.- 203 BAGHAJATIN G BLOCK, AT C.S. DAG NO. - 365, C.S. KHATIAN NO. - 137, R.S. DAG NO. - 369, R.S. KHATIAN NO.- 108, MOUZA - BADEMASHAR, J.L. NO. - 31, PARGANA - KHASPUR, R.S. NO. - 17, TOUZI NOS. - 246, 1516-1518, P.S. - PATULI, UNDER THE JURISDICTION OF KOLKATA MUNICIPAL CORPORATION, WARD NO -101, BOROUGH - XII, KOLKATA - 700084.

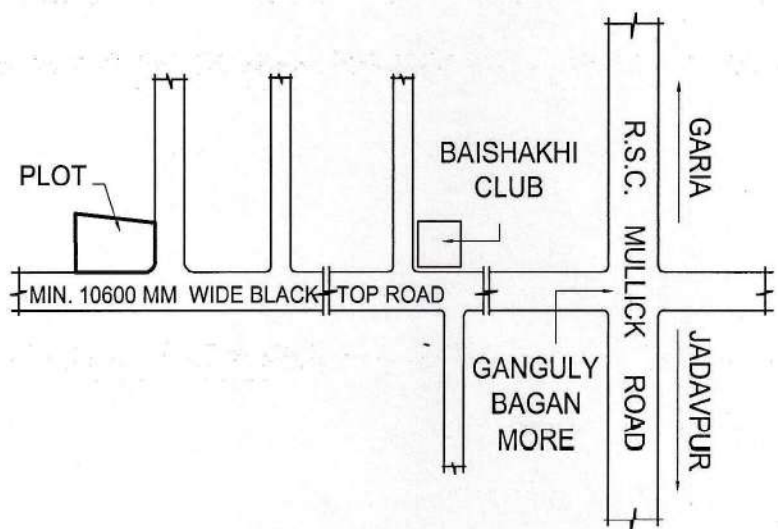

LAT: 22.28364°  
LONG: 88.22442°

**LOCATION PLAN**  
SCALE - 1:4000

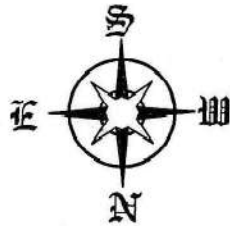
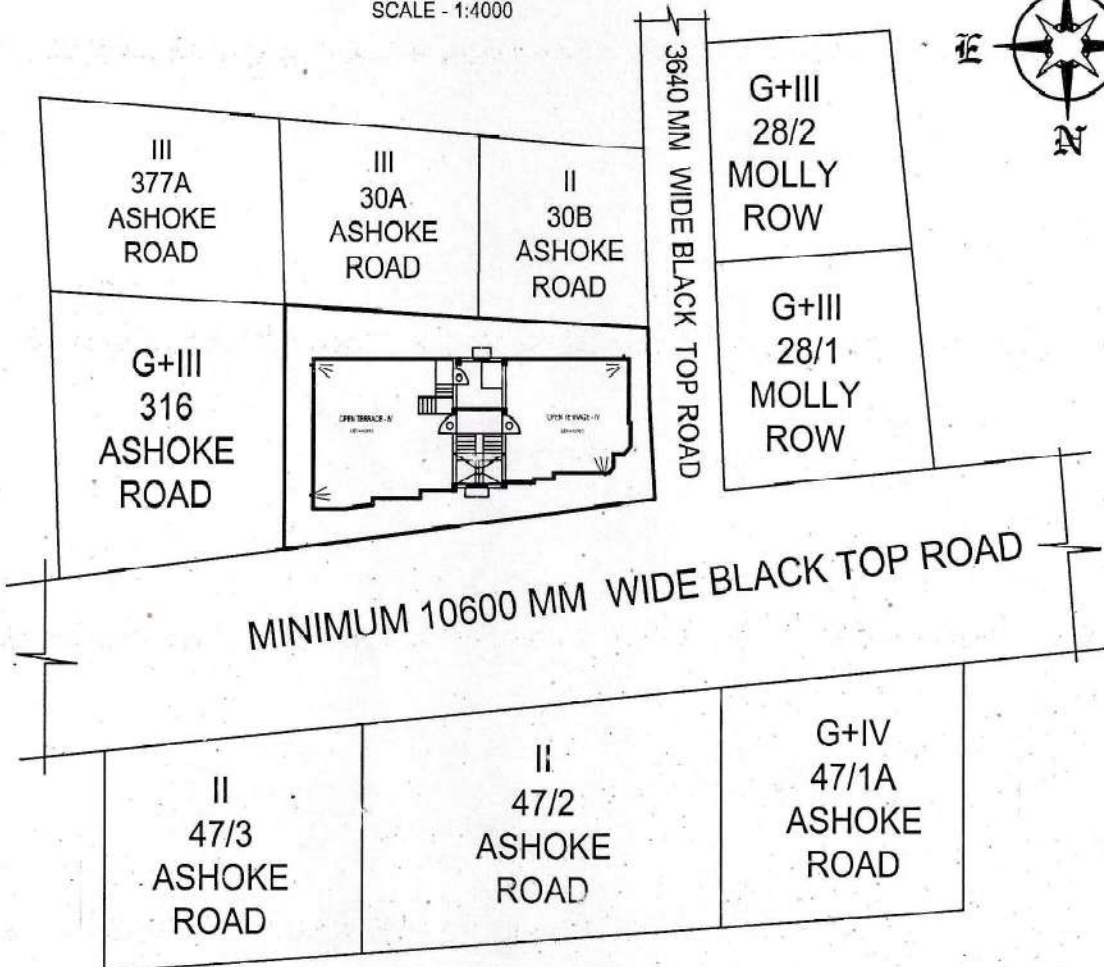

**SITE PLAN**  
SCALE - 600

*S. S. Enterprise*  
*Snigdha Saha*  
Proprietor